

# Installation Instructions for the RX 3/8 to 1 1/2 in with Rotating Syphon

 [fluidhandling.kadant.com/en/knowledge-center/installation-and-repair-instructions/rx-rotary-union/rx-3-8-1-1-2-in-rotating-syphon](https://fluidhandling.kadant.com/en/knowledge-center/installation-and-repair-instructions/rx-rotary-union/rx-3-8-1-1-2-in-rotating-syphon)

Effective: March 11, 2024

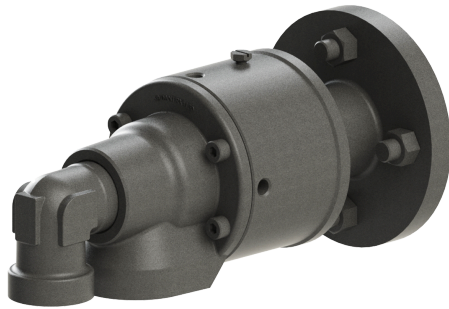

## Introduction

Read all of the instructions before proceeding.

Refer to Kadant Johnson assembly drawing for part identification and to drawing A37640 for torque specifications. For easy identification, parts used in individual steps are often accompanied with their position in the assembly drawing [e.g. gasket (8B)]. Tighten all fasteners in a star pattern. Certified

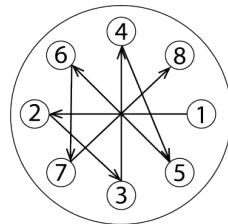

drawings are available upon request. Dimensions are for reference only and subject to change.

## Safety

 This safety symbol alerts you to risk of death or injury if the instructions are not followed. In all steps, death or injury may result if the machine is not de-energized, depressurized, cooled, and stopped. Death or injury may occur if the product is operated with a fluid type or at a pressure, temperature, or speed that do not meet its specifications. Death or injury may occur if heavy parts and pinch hazards are not handled properly. Follow your company's safety procedures.

## Step 1

Remove the existing equipment. If installing a new journal flange remove the existing and clean all sealing surfaces.

**NOTE:** There are three different ways to attach the rotary joint to the roll. For a threaded nipple proceed to Step 2, quick release Step 3, and integral flanged Step 4.

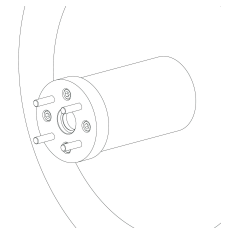



 Equipment must be cool and free of pressure.

## STEP 2, THREADED NIPPLE

---

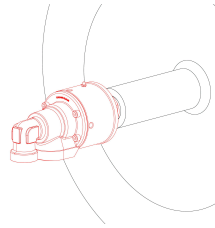
Carefully thread the supply pipe into the rotary union elbow (2). Using the required sealant for your threaded nipple, thread the nipple (4) into the journal and tighten: Pipe sealant for tapered threads; gasket for straight threads; O-Ring for C.A.M.M. Proceed to Step 5.



 Use caution during this step. Internal seals can be damaged.

 Pay special attention to the length of the supply pipe. Excess length or a pipe that is short will cause the rotary joint to not function correctly.

## STEP 3A, QUICK RELEASE NIPPLE

---

Slide the nipple flange over the rotary joint nipple with the taper facing out. Place the split wedges into the recess of the nipple. Slide the nipple flange over the wedges.

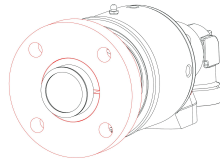



## STEP 3B

---

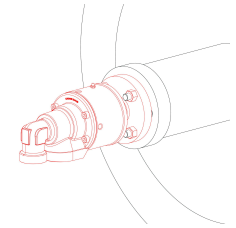
Place metal gasket (8Q) into the journal flange. Lift the rotary joint up, slide over the supply pipe and into the journal flange. Secure to studs with nuts. An even gap of 1/8" to 3/16" (3 to 5 mm) should remain in between the journal flange and nipple flange. Proceed to Step 5.



 Use caution during this step. Internal seals can be damaged.

 Pay special attention to the length of the supply pipe. Excess length or a pipe that is short will cause the rotary joint to not function correctly.

## Step 4, INTEGRAL FLANGED NIPPLE

---

Place gasket on nipple flange. Lift the rotary joint up, slide over the supply pipe, and slide over the studs on the journal. Secure with hex nuts. Proceed to Step 5.

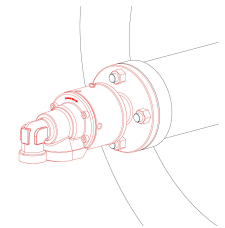

## Step 5

---

Pay special attention to concentricity. At high-speeds the bearing will yield longer, trouble-free service if runout is kept to a minimum.

## Step 6

Connect the piping to rotary joint using rubber hose or Kadant Johnson flexible metal hose. Hose ratings must be able to sustain the media flow.

<b>Recommended Minimum Hose Lengths For Flexible Metal Hose</b>	
<b>Pipe Size</b>	<b>Minimum Length</b>
1/4"	8" (200 mm)
3/8"	10" (250 mm)
1/2"	10" (250 mm)
3/4"	12" (300 mm)
1"	15" (380 mm)
1 1/4"	18" (450 mm)
1 1/2"	18" (450 mm)

## Step 7

There are four vent holes located on the body (1). They provide an escape path in case the seal package leaks and also prevent fluid from flooding the bearing cavity. Ensure that one hole is positioned down and plug the other 3. A flexible drain line may be attached if needed.

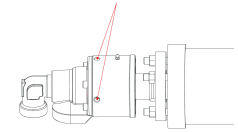

### IS RX 3/8" to 1 1/2" Rotating Syphon

#### The Kadant Johnson Warranty

Kadant Johnson products are built to a high standard of quality. Performance is what you desire: that is what we provide. Kadant Johnson products are warranted against defects in materials and workmanship for a period of one year after the date of shipment. It is expressly understood and agreed that the limit of Kadant Johnson's liability shall, at Kadant Johnson's sole option, be the repair or resupply of a like quantity of non-defective product.

Kadant Johnson rotary joints and accessories could be subject to European Pressure Equipment Directive 2014/68/EU (PED). Modifications or changes to rotary joints and/or accessories are only permitted upon approval of Kadant Johnson. Only genuine Kadant parts and original accessories will ensure the safety of these assemblies. The use of other than original parts voids the warranty and will lead to forfeiture of the declaration of conformity and will invalidate any liability for damages cause thereby.